

PROJECTION

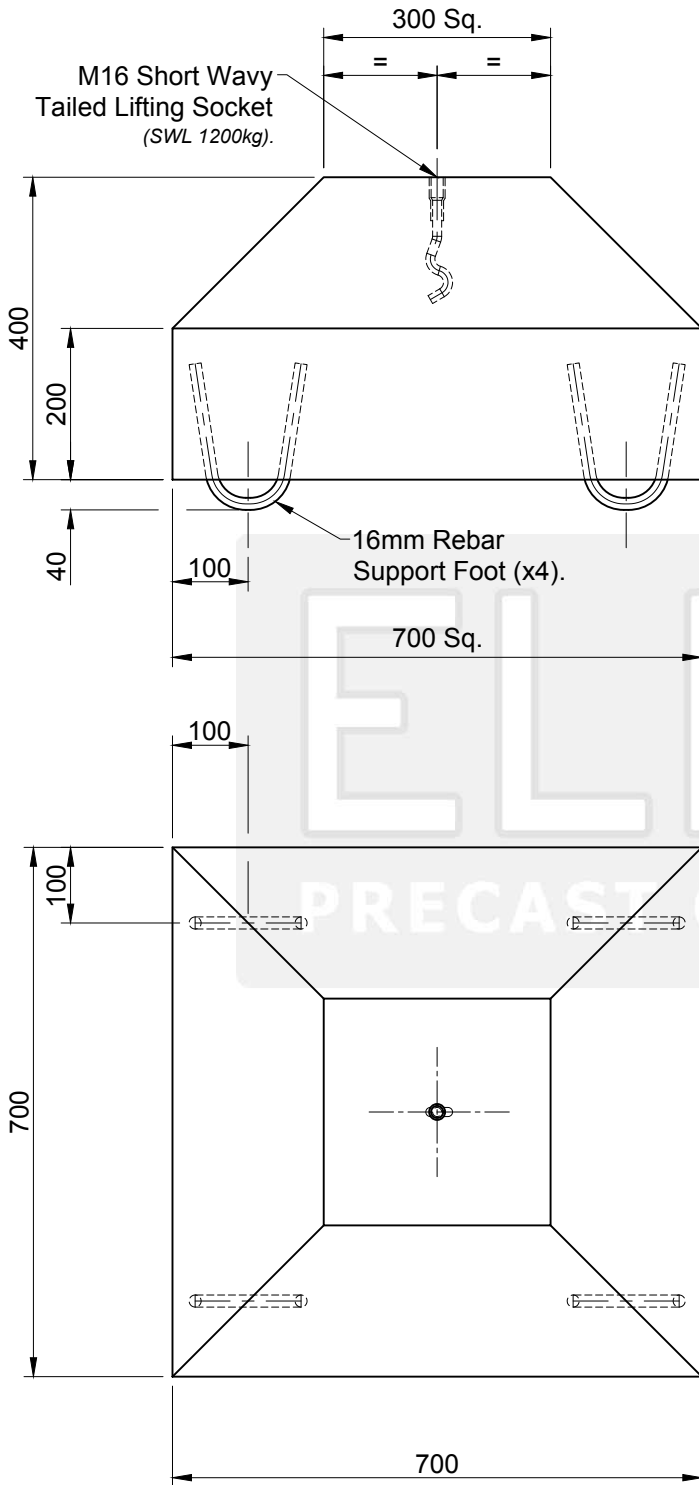
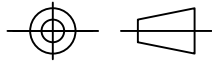

1. Handling

- Unit Volume / Weight

Unit Ref	Volume (m ³)	Weight (kg)	Weight +5% (kg)
-	0.1507	360	378

- Weight is based on 2350 kg/m³
- Lifting system is by means of M16 threaded lifting loops, combination lifting loops or lifting eyes, and should comply with the Lifting Operation & Lifting Equipment Regulations 1998 (LOLER).

2. Concrete

- Lifting strength is based on 2 cubes = 15 N/mm²
- Characteristic 28 day cube strength = 50 N/mm² min
- Concrete provides Design Chemical Class 2 (DC2) to special Digest 1, Table D2.
- Concrete is Class A1 Fire Resistant in accordance with clause 4.3.4.4 of EN 13369.

3. Physical & Chemical Properties

- Appearance : Grey in colour
- Other Chemical Properties : Not Applicable

4. Design

- Design Life : >100 years

5. Manufacture Tolerances

- Length ± 5mm
- Width ± 5mm
- Height ± 5mm

					O	15.07.15	For Information		CTC	RMD			
REV	DATE	REASON FOR ISSUE	DRN	APP	REV	DATE	REASON FOR ISSUE	DRN	APP				
TITLE				Elite Product Code : -				Sea Anchor Block					
				ELITE PRECAST CONCRETE LIMITED HALESFIELD 9, TELFORD SHROPSHIRE TF7 4QW									
DRN	CTC	CHKD	RMD	DATE	15-07-15	SIZE	A4	SCALE	1:10	DRG	EPC-SEA-001	REV	O